

SIZES: 8NB - 50NB

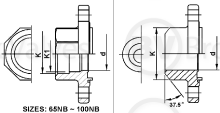

SIZES: 65NB - 100NB

**SOCKET WELD END**

**BUTT WELD END**



SIZES: 8NB - 15NB

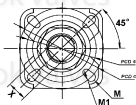

SIZES: 20NB - 50NB

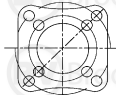

SIZES: 65NB - 100NB

NO	PART NAME	MATERIAL	QTY
1	BODY	ASTM A351 CF8M	1
2	CAP	ASTM A351 CF8M	2
3	BALL	ASTM A351 CF8M	1
4	BALL SEAT	15% R - PTFE	2
5	JOINT GASKET	15% R - PTFE	2
6	STEM	AISI 316	1
7	THRUST WASHER	15% R - PTFE	1
8	STEM PACKING	15% R - PTFE	2
9	STEM RING	AISI 304	1
10	BELLEVILLE WASHE	AISI 304	2
11	C-RING	K5	2
12	O-RING	VITON	1
13	BOLT	AISI 304	4
14	SPRING WASHER	AISI 304	4
15	HEX NUT	AISI 304	4

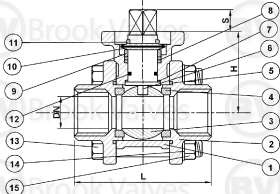

REV A	<b>BROOK VALVES</b>	
DATE	MAY 2005	<b>V3MHC</b>
SCALE	TO FIT	Page 1 of 2
<b>3-PCE BALL VALVE FB BSP ENDS with ISO MOUNTING PAD</b>		