

TEST PRESSURE BAR / PSI		
API 6D	SHELL	SEAT
HYDROSTATIC	75 / 1087	55 / 798

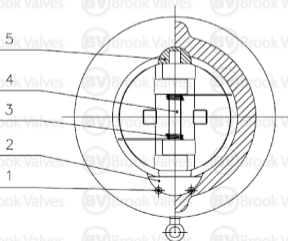
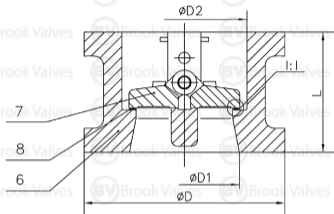

NO.	PART NAME	MATERIAL
1	SCREW	A276 316
2	WASHER	A276 316
3	SPRING	INCONEL X-750
4	HINGE PIN	A276 316
5	PIN SEAT	A276 316
6	BODY	A351 CF8M
7	DISC	A351 CF8M
8	SEAT	SS316 OVERLAYED

SIZE: MM

SIZE	L	D	D1	D2
50	60	110	50	60
65	67	128	65	65
80	73	147	80	88
100	73	179	100	104
125	86	214	125	129
150	98	249	150	160
200	127	305	203	210
250	146	359	254	266
300	181	420	300	290
350	222	483	350	340
400	232	537	400	390
450	264	594	450	440
500	292	652	500	490
600	318	772	600	580

DESIGN & MFT	API 594	END CONNECTIONS	WAFER
PRE-TEMP RATING	ASME B16.34	INSPECT & TEST	API 598
F-F DIMENSION	API 594	FLANGED DIMENSION	ASME B16.5
MARKING	MSS-SP-25	FIRE SAFE DESIGN	NA
PAINTING	BARE FINISH	LOGO	BV IN A CIRCLE

TO NACE MR-01-75 ON REQUEST

REV	B	<b>BROOK VALVES</b> <b>SS300 316 DUO MM</b>
DATE	Jun-20	
SCALE	TO FIT	
300 LB CF8M DUAL PLATE WAFER TYPE CHECK VALVE (RETAINERLESS)		